



## Raised Expectations

NESTLED IN A wooded nook of the northeast, this outdoor living space started with a simple request to remove a side rail to accommodate a grill, burner, and sink. But as these Greenwich, Connecticut, homeowners continued working with designer Michael Gotowala, president of Preferred Properties Landscaping & Masonry, their expectations began to rise—figuratively and literally.

Desiring a more complete cooking area as well as immediately accessible dining and lounging areas, the homeowners quickly expanded the project's scope to also include a wraparound kitchen island with bar seating and beverage center, a designated dining area, and a focal-point masonry fireplace with Tuscany-inspired pizza oven—all of which are located 30 feet in the air on the second-level deck.

Building such an elaborate setup on the second level was no simple task but was well worth the effort. By locating these living spaces on the second level, the owners gained a greater level of seclusion, privacy, and security. The of-the-earth materials and neutral tones blend beautifully with the natural landscape, which is heavily treed and includes a pond on the property. Below the deck, an outdoor wine tasting room is a great starting place for guests before moving upstairs to settle in and enjoy the scenery. *Learn more about this designer at [www.outdoorlivingct.com](http://www.outdoorlivingct.com) or [www.outdoorkitchendesigner.com](http://www.outdoorkitchendesigner.com).*

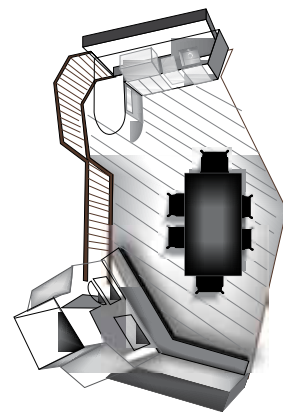

### DESIGNER

Michael Gotowala  
Preferred Properties  
Landscaping & Masonry  
1456 Highland Ave.  
(Route 10)  
Cheshire, CT 06410  
203.250.1030

### SPECIAL FEATURES

Second-level locale,  
stone wraparound  
island, masonry fireplace  
with Tuscany-style pizza  
oven

### FEATURED PRODUCTS

Cabinetry: Danver  
stainless steel  
Flooring: Opaq decking  
Countertops: Polished  
granite  
Sink: Famer's sink  
Faucet: Moen  
Grill: DCS by Fisher &  
Paykel 48-inch infrared  
grill  
Side Burner: Sol-Aire  
Refrigerator: Summit  
Lighting: Preferred  
Properties Landscaping  
& Masonry  
Wallcovering: Stone

PHOTOGRAPHER: MICHAEL GOTOWALA

